

**Stainless Steel /
Stainless Steel
Blind Rivet
Dome Head**

Length Unit: mm

d	L	Grip Range		Hole Size	dk	k	dm	p	Minimum Compressive	Minimum Shear Force
	max	min	max	Φ		max	max	min	KN	KN
Φ4.8	18.2	1.63	6.86	4.9-5.1	10.1	2.1	3.1	27	4.5	6.0
	24.4	1.63	11.10						4.5	6.0
Φ6.4	23.7	2.03	9.53	6.7-7.0	13.3	2.9	4.1	27	8.2	10.5
	32.9	2.03	15.87						8.2	10.5

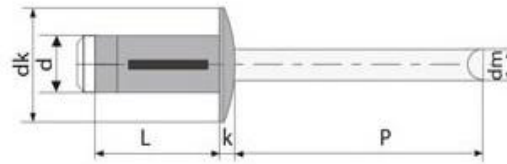

**Stainless Steel /
Stainless Steel
Blind Rivet
Countersunk Head**

Length Unit: mm

d	L	Grip Range		Hole Size Φ	dk	k	dm	p	Minimum Compressive	Minimum Shear Force
		min	max						KN	KN
Φ4.8	20.0	3.17	8.41	4.9-5.1	8.5	2.2	3.1	27	4.1	5.8
	26.2	3.17	12.22						4.1	5.8
Φ6.4	26.4	3.17	12.07	6.7-7.0	10.1	2.4	4.1	27	8.2	10.5

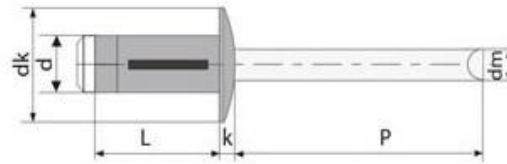

**Steel/Steel
Blind Rivet
Dome Head**

Length Unit: mm

d	L	Grip Range		Hole Size	dk	k	dm	p	Minimum Compressive	Minimum Shear Force
	max	min	max	Φ		max	max	min	KN	KN
Φ4.8	18.2	1.63	6.86	4.9-5.1	10.1	2.1	3.1	27	4.1	5.8
	24.4	1.63	11.10						4.1	5.8
Φ6.4	23.7	2.03	9.53	6.7-7.0	13.3	2.9	4.1	27	8.2	10.5
	32.9	2.03	15.87						8.2	10.5

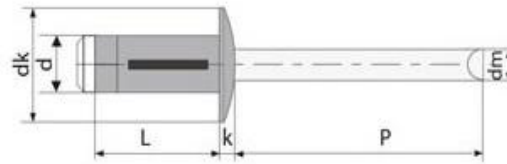

Steel/Steel Blind Rivet Countersunk Head

Length Unit: mm

d	L	Grip Range		Hole Size Φ	dk	k	dm	p	Minimum Compressive	Minimum Shear Force
		min	max						KN	KN
Φ4.8	20.2	3.17	8.41	4.9-5.1	8.5	2.2	3.1	27	4.1	5.8
	26.5	3.17	12.22						4.1	5.8
Φ6.4	28.3	4.32	12.06	6.7-7.0	10.1	2.4	4.1	27	8.2	10.5