

**Stainless Steel/
StainlessSteel
Blind Rivet
Dome Head**

Length Unit: mm

d	L	Grip Range		Hole Size	dk	k	dm	p	Minimum Compressive	Minimum Shear Force
	max	min	max	Φ		max	max	min	KN	KN
Φ4.8	18.2	1.58	6.85	4.9-5.1	10.2	2.3	3.1	27	4.5	6.0
	24.6	1.58	11.09						4.5	6.0
Φ6.4	25.3	2.04	9.52	6.7-7.0	13.5	2.9	4.1	27	8.2	10.5
	35.6	2.04	15.87						8.2	10.5

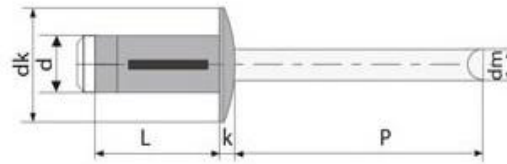

**Stainless Steel/
StainlessSteel
Blind Rivet
Countersunk Head**

Length Unit: mm

d	L	Grip Range		Hole Size Φ	dk	k	dm	p	Minimum Compressive	Minimum Shear Force
		min	max						KN	KN
Φ4.8	20.2	3.17	8.41	4.9-5.1	9.2	2.3	3.1	27	4.5	6.0
	26.5	3.17	12.22						4.5	6.0
Φ6.4	28.3	4.32	12.06	6.7-7.0	11.4	2.2	4.1	27	8.2	10.5

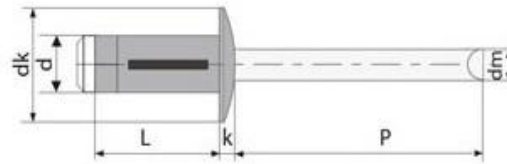

**Steel/Steel
Blind Rivet
Dome Head**

Length Unit: mm

d	L	Grip Range		Hole Size	dk	k	dm	p	Minimum Compressive	Minimum Shear Force
	±0.99	min	max	Φ		max	max	min	KN	KN
Φ4.8	18.2	1.58	6.85	4.9-5.1	10.2	2.3	3.1	27	4.4	5.6
	24.6	1.58	11.09						4.4	5.6
Φ6.4	25.3	2.04	9.52	6.7-7.0	13.5	2.9	4.1	27	8.2	10.5
	35.6	2.04	15.87						8.2	10.5

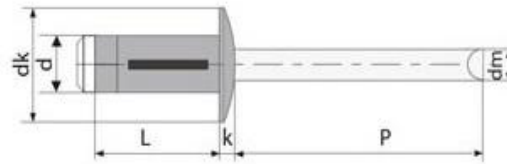

Steel/Steel Blind Rivet Countersunk Head

Length Unit: mm

d	L	Grip Range		Hole Size Φ	dk	k	dm	p	Minimum Compressive KN	Minimum Shear Force KN
		min	max							
Φ4.8	20.2	3.17	8.41	4.9-5.1	9.2	2	3.1	27	4.0	5.4
	26.5	3.17	12.22							
Φ6.4	28.3	4.32	12.06	6.7-7.0	11.4	2.2	4.1	27	8.2	10.5